

**ASBESTOS**  
**YOUR DUTY**



# Campaign toolkit



Asbestos is the single greatest cause of work-related deaths in the UK with over five thousand asbestos-related deaths a year.

Do you know where there is asbestos in your building?



# Introduction

This campaign toolkit will give you an overview of our 'Asbestos - Your Duty' campaign and how you and your organisation can support the campaign to raise awareness of the health risk of exposure to asbestos fibres and the legal duty to manage asbestos in non-domestic buildings to protect workers and others from the risks.

Asbestos is the single greatest cause of work-related deaths in the UK with over five thousand asbestos-related deaths a year.

Asbestos containing materials were used extensively in the construction and maintenance of buildings in Great Britain from the 1950s until they were banned by 1999. That means people who work in older buildings could still be exposed to asbestos fibres today unless the risks are managed effectively with an active asbestos management plan.

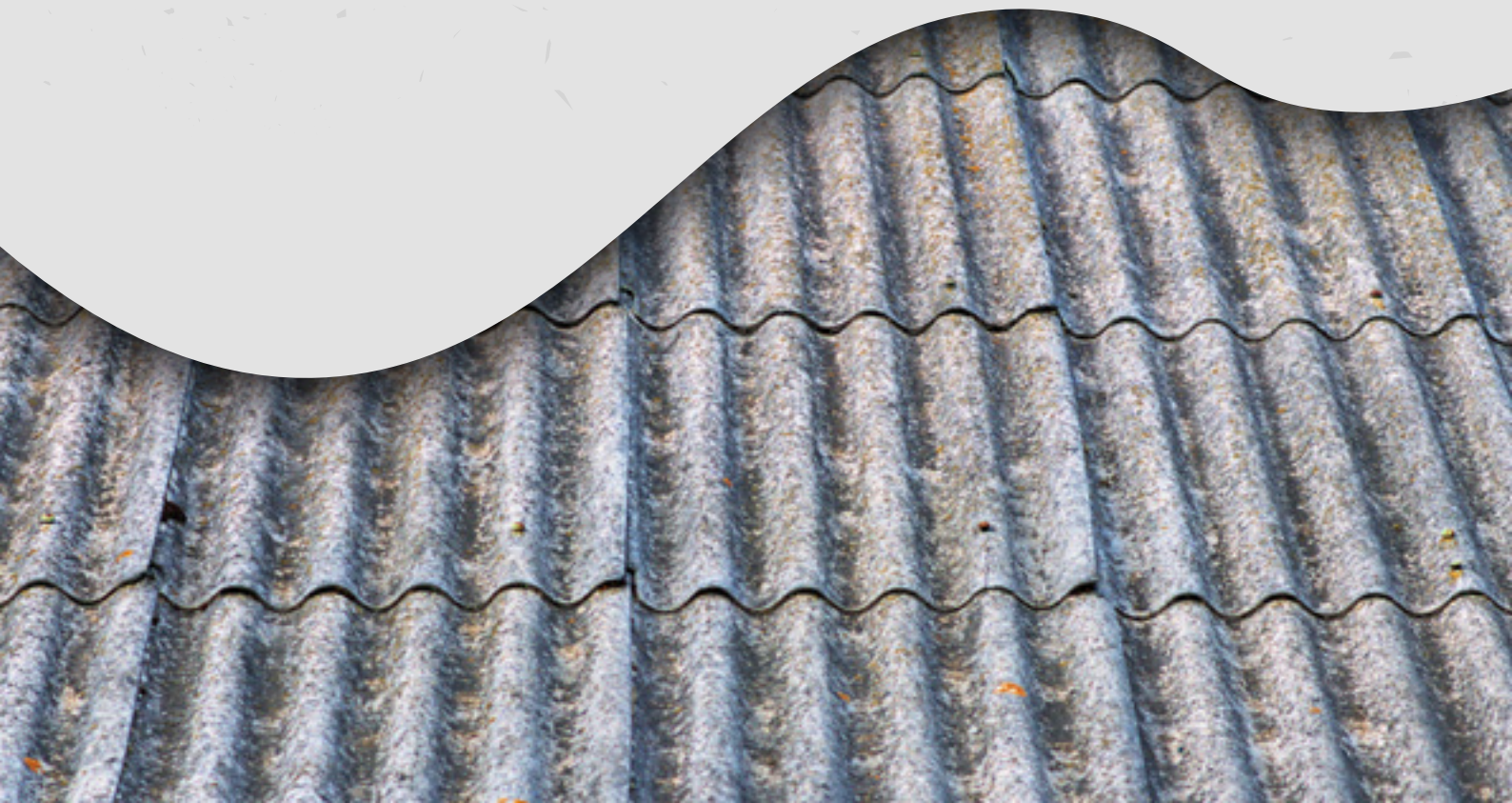





## What are the risks?

Asbestos fibres are too small to be seen by the naked eye. If asbestos fibres are inhaled, they can cause **serious, often extremely debilitating and fatal, diseases** such as mesothelioma, asbestos related lung cancer, asbestosis, and pleural thickening.





# Where are asbestos containing materials found?

Despite being banned, asbestos containing materials, often know as ACMs are still found in buildings built before 2000. Amongst others, asbestos containing materials can include:

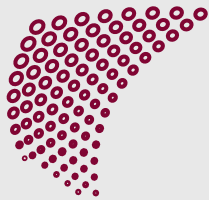

Textured decorative coatings



Sprayed coatings

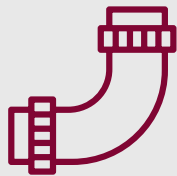

Pipe/Boiler insulation



Asbestos cement



Asbestos insulating board



Floor tiles

You can find out more about where asbestos hides on [HSE's website](#)





# Who has a duty to manage asbestos?

There is a legal duty to manage the risks of asbestos in buildings. The duty to manage asbestos covers all non-domestic premises, including all **industrial, commercial** or **public buildings** such as **factories, warehouses, offices, shops, hospitals** and **schools**.

The person who has the duty to manage asbestos is referred to as the 'dutyholder'.

The dutyholder will be the person or organisation with the main responsibility for maintenance or repair of the building. This could be the:

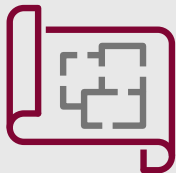

Building  
owner



Landlord  
for the  
premises

A person or organisation could have the responsibility for maintenance or repair through a tenancy agreement or contract.

We have developed a few short questions to help identify if you are the dutyholder with a legal duty to manage asbestos.

[View the questions here.](#)





# How do I comply with the law?

Asbestos can still be found in older buildings and must be managed effectively to prevent exposure to asbestos fibres if damaged or disturbed.

Asbestos can be visible and hidden within the building fabric. Follow these steps to comply with your legal duty:

- 1** Find out if asbestos could be present in your building
- 2** Arrange an asbestos survey
- 3** Make a register and assess the risk from your asbestos
- 4** Write your asbestos management plan
- 5** Put your plan into action
- 6** Continually monitor and communicate the plan





# Draft Newsletter

If you would like to share the news on your own channels, please see some suggested wording below. Feel free to include more information relevant to your sector, as well as a quote from a spokesperson from your organisation.

The Health and Safety Executive (HSE) has launched a new campaign to highlight the risk of asbestos in buildings and raise awareness of the legal duty to manage those risks.

HSE's Asbestos – Your Duty campaign targets those responsible for managing asbestos in the building (dutyholders), which could be the building owner, the landlord for the premises, the business owner, or the person or organisation with clear responsibility for the building's maintenance or repair.

The duty to manage asbestos ensures dutyholders must protect people from the risks of exposure to asbestos, including people who work in or on their buildings, and people that use them in other ways.

The duty applies to a range of buildings, including non-domestic premises like factories, warehouses, offices and shops; and public buildings like hospitals, schools, premises used for religious worship, and museums and libraries. In addition, common parts of domestic premises are included such as foyers and corridors, lifts and lift-shafts, and staircases.

The Asbestos – Your Duty campaign provides dutyholders with a range of resources including updated webpages, new templates – including an asbestos management plan template, and explanatory videos – all of which can be found on HSE's website.

A few simple questions can help identify if you have a legal duty to manage asbestos:

[Answer the questions here](#)

More information about the duty to manage asbestos can be found by [visiting HSE's website](#)



# Social Media

We're asking for support in sharing these important messages on your own social media, see some suggested posts below and accompanying social graphics. More graphics are available on the [campaign resource hub](#).

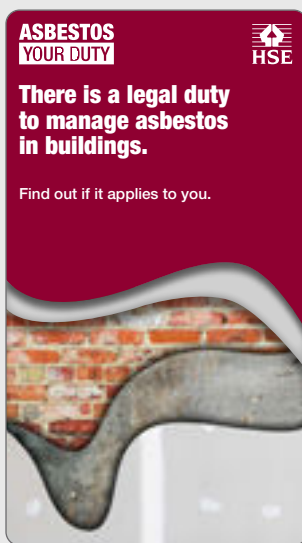

## Social Post 1:

We are supporting Asbestos – Your Duty, a new campaign launched by HSE (tag HSE) to raise awareness of the dangers of asbestos and the legal duty to manage asbestos in buildings.

<https://www.hse.gov.uk/asbestos/duty/>

## Social Post 2:

Asbestos didn't disappear when it was banned in the UK. There is a legal duty to manage the risk of asbestos in buildings. HSE (tag HSE) has guidance and templates to help duty holders comply with the law and protect workers' health.

<https://www.hse.gov.uk/asbestos/duty/>



# Get in touch

We would welcome you to get in touch with us for clarity, advice or a chat on any opportunities you have in mind. If you would like to get involved please contact [campaigns@hse.gov.uk](mailto:campaigns@hse.gov.uk)

Follow us on social media:

 [@hsegovuk](https://www.facebook.com/hsegovuk)

 [@H S E](https://twitter.com/HSE)

 [Health and Safety Executive](https://www.linkedin.com/company/health-and-safety-executive)

